

Black Powder Coated Aluminum Handwheels with fold-away handle

- ▶ Black powder coated cast aluminum
- ▶ Installed manual fold-away handle
- ▶ Through bore

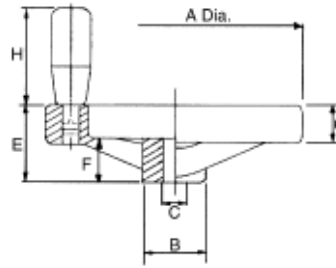

PART #	A	B	Bore C	E	F	G	H
HW-50A	4.00	1.25	.375	1.77	.812	.750	2.20
HW-50B	4.00	1.25	.500	1.77	.812	.750	2.20
HW-51A	5.00	1.31	.375	1.93	.875	.750	2.56
HW-51B	5.00	1.31	.500	1.93	.875	.750	2.56
HW-52A	6.00	1.44	.500	2.05	1.00	.750	2.56
HW-52B	6.00	1.44	.625	2.05	1.00	.750	2.56
HW-53A	8.00	1.94	.500	2.74	1.38	.937	3.15
HW-53B	8.00	1.94	.625	2.74	1.38	.937	3.15
HW-54A	10.00	1.94	.625	2.80	1.38	.937	3.15
HW-54B	10.00	1.94	.750	2.80	1.38	.937	3.15

Two-Spoke Aluminum Handwheels

- ▶ Made from cast aluminum
- ▶ High quality machined and polished finish
- ▶ Available with or without revolving plastic handle
- ▶ Through bore

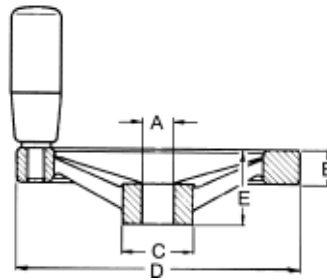

Without handle PART #	With handle PART #	D	A	B	C	E
HW-30	HW-30H	4.92	.47	.59	1.22	1.30
HW-31	HW-31H	6.30	.55	.71	1.42	1.54
HW-32	HW-32H	7.87	.71	.80	1.65	1.77
HW-33	HW-33H	9.84	.87	.91	1.89	2.01

Solid Web Aluminum Handwheels

- ▶ Made from cast aluminum
- ▶ High quality machined and polished rim
- ▶ Solid web design has no hazardous openings
- ▶ Available with or without revolving black plastic handle
- ▶ Through bore

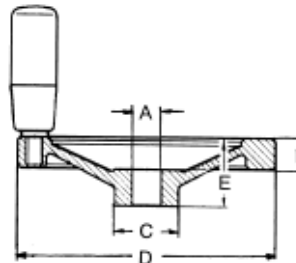

Without handle PART #	With handle PART #	D	A	B	C	E
HW-20	HW-20H	3.94	.39	.55	1.10	1.18
HW-21	HW-21H	4.92	.47	.59	1.22	1.30
HW-22	HW-22H	6.30	.55	.71	1.42	1.54
HW-23	HW-23H	7.87	.71	.80	1.65	1.77
HW-24	HW-24H	9.84	.87	.91	1.89	2.01